

11/9/2010

TOOLS REQUIRED: PHILLIPS SCREWDRIVER 5MM ALLEN WRENCH FILE FLAT BLADE SCREWDRIVER
SIDE CUTTERS/UTILITY KNIFE 8MM WRENCH ALLEN WRENCH SET

HARDWARE INCLUDED:

(3) M6-1.0 X 50MM LONG HEX HEAD FLANGE SCREW	(3) M6-1.0 X 32MM LONG HEX HEAD FLANGE SCREW	(3) WIRE TIES
(4) M5-0.8 X 20MM LONG PHILLIPS PAN HEAD MACHINE SCREW		(1) RELAY
(2) SPACER 6.5MM I.D. X 13MM O.D. X 16MM LONG	(1) SPACER 5.5MM I.D. X 13MM O.D. X 4MM LONG	(2) SPRINGS
(4) SHORT FLANGE COLLAR	(6) LONG FLANGE COLLAR	(2) BLIND NUT
(6) LARGE RUBBER GROMMET	(6) FLAT WASHER 7.5MM I.D. X 22MM O.D. X 1.5 THICK	(1) WIRE HARNESS
(6) FLAT WASHER 5.5MM I.D. X 16MM O.D. X 1.0 THICK	(1) SWITCH WIRE HARNESS	(2) LED FOG LIGHTS
(6) M4-0.7 X 10MM LONG PHILLIPS PAN HEAD SCREW	(1) FOG LIGHT JUMPER PLUG	
(4) SMALL RUBBER GROMMET	(1) RIGHT SIDE MOUNTING BRACKET #1	
(1) LEFT SIDE MOUNTING BRACKET #1	(2) RIGHT SIDE MOUNTING BRACKET #2	
(1) LEFT SIDE MOUNTING BRACKET #2	(2) M5-0.8 X 37MM LONG PHILLIPS PAN HEAD MACHINE SCREW WITH PILOT POINT	

NOTE: BIG BIKE PARTS RECOMMENDS USING THREADLOCKER ON ALL HARDWARE.

1. PLACE THE BIKE ON ITS CENTER STAND.
2. DISCONNECT THE NEGATIVE BATTERY CABLE.
3. USING 5MM ALLEN WRENCH REMOVE THE SIX BOLTS (1A) FROM THE FRONT COWL (1B).
4. REMOVE THE TWO TRIM CLIPS (1C) AND REMOVE THE FRONT COWL (1B).
5. USING SIDE CUTTERS OR UTILITY KNIFE REMOVE THE KNOCK OUTS (1D) FROM FRONT COWL (1B). USE A FILE TO SMOOTH EDGES.
6. INSTALL THE GROMMETS (2A) IN THE HOLES ON THE RIGHT (2B) AND LEFT (2C) MOUNTING BRACKETS AS SHOWN IN FIGURE 2.
7. INSTALL THE RIGHT BRACKET (3A) ON THE FOG LAMP (3B) AS SHOWN IN FIGURE 3. DO THE SAME FOR THE LEFT SIDE (3C) & (3D). REFER TO FIGURE 3.
8. USING THE 8MM WRENCH REMOVE THE TWO BOLTS (4A) HOLDING THE PLASTIC TRIM PIECES ON THE RIGHT SIDE. INSTALL THE RIGHT FOG LAMP (4C) BY USING THE SHORT FLANGE COLLARS (4D), SHORT SPACER (*01 – *05 MODELS ONLY) (4E), SHORT FLANGE BOLTS (4F) AND WASHERS (4G). PLUG THE 2-PIN GRAY CONNECTOR (4H) INTO THE MOTORCYCLES 2-PIN GRAY CONNECTOR (4I). REMOVE THE PLUG COVER FIRST. THE MOTORCYCLE CONNECTOR MAY BE TAPED TO THE BIKE. THIS TAPE WILL HAVE TO BE REMOVED TO LENGTHEN WIRES. REFER TO FIGURE 4.
9. USING THE 8MM WRENCH REMOVE THE TWO BOLTS (5A) HOLDING THE PLASTIC TRIM PIECE (5B) ON THE LEFT SIDE. INSTALL THE LEFT FOG LAMP (5C) BY USING THE LONG FLANGE COLLARS (5D), THE TWO MEDIUM SIZE SPACERS (5E), THE LONG SPACER (5F), THE LONG FLANGE BOLT (5G), AND WASHERS (5H). PLUG THE 2-PIN GRAY CONNECTOR (5I) INTO THE MOTORCYCLES 2-PIN GRAY CONNECTOR (5J). REMOVE THE PLUG COVER FIRST. THE MOTORCYCLE CONNECTOR MAY BE TAPED TO THE BIKE. THIS TAPE WILL HAVE TO BE REMOVED TO LENGTHEN WIRES. REFER TO FIGURE 5.
10. REMOVE THE LEFT SIDE FAIRING TRIM MOLDING (6A). REFER TO FIGURE 6.
11. REMOVE THE ALLEN BOLT (6B) AND REMOVE THE LEFT CONTROL PANEL (6C).
12. REMOVE THE SWITCH COVER (7E) ON THE BACK OF CONTROL PANEL (7C). REFER TO FIGURE 7.
13. REMOVE THE TWO SCREWS (7A) HOLDING THE SWITCH HOLE COVER (7B) TO THE CONTROL PANEL (7C).
14. INSTALL THE SWITCH (7D) USING THE SCREWS (7A) REMOVED IN THE PREVIOUS STEP.
15. PLUG THE 4-PIN SWITCH CONNECTOR (6D) INTO THE RELAY HARNESS (6E). PLUG THE RELAY HARNESS (6E) INTO THE MOTORCYCLES ACCESSORY BLACK 4-PIN CONNECTOR (6F).

NOTE: THIS KIT COMES WITH A RELAY AND A JUMPER PLUG (6G). IF THE RELAY IS USED, THE KIT WILL FUNCTION AS OEM AND THE FOG LIGHTS WILL TURN OFF WITH THE HIGH BEAMS. IF THE JUMPER PLUG IS USED, THE FOG LIGHTS WILL ONLY TURN OFF WITH THE SWITCH.

16. BEFORE INSTALLING ALL REMOVED COMPONENTS BE CERTAIN THAT THE LIGHTS WORK AND ARE AIMED CORRECTLY. TO CHECK THE AIM, PARK THE BIKE ON A LEVEL SURFACE ABOUT 16 FEET FROM A WALL OR OTHER VERTICAL SURFACE. MEASURE THE DISTANCE FROM THE FLOOR TO THE CENTER OF THE FOG LIGHT (APPROXIMATELY 16 INCHES). THE TOP EDGE OF THE LIGHT PATTERN ON THE WALL SHOULD BE THE SAME DISTANCE TO THE FLOOR AS THE FOG LAMP MOUNTING HEIGHT. IF THE LIGHTS NEED ADJUSTMENT YOU CAN SCREW IN OR OUT THE ADJUSTMENT SCREW ON EACH BRACKET. SEE FIGURE 2 FOR THE LOCATION OF THE AIMING ADJUSTMENT SCREWS (2D).
17. REINSTALL THE CONTROL PANEL & FAIRING TRIM MOLDING IN THE REVERSE OF REMOVAL.

BULBS NON REPLACEABLE

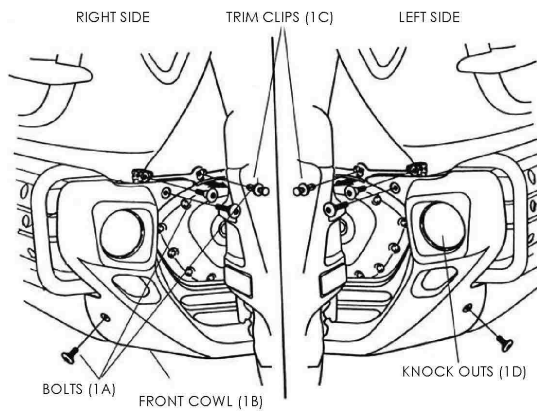

FIG. 1

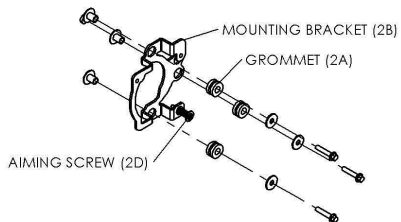

FIG. 2

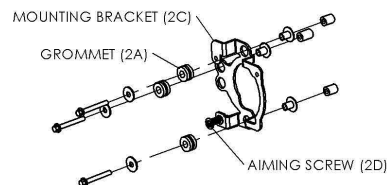

FIG. 3

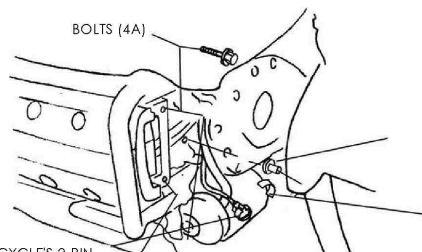
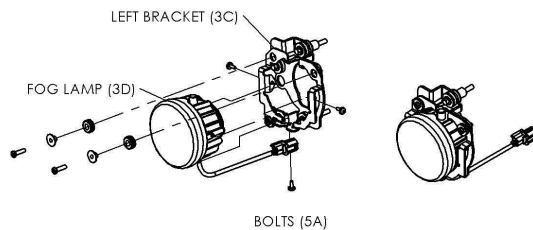
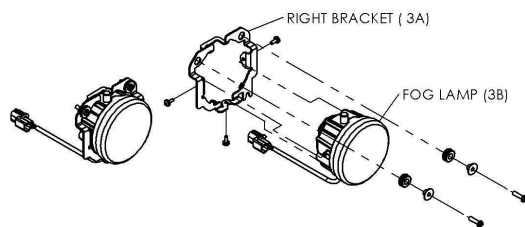

FIG. 4

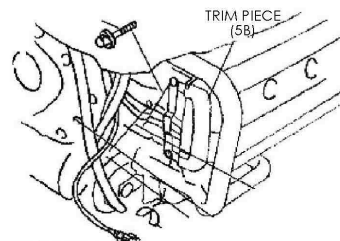

FIG. 5

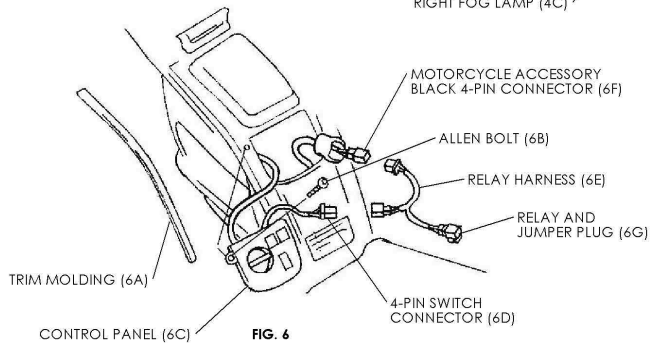
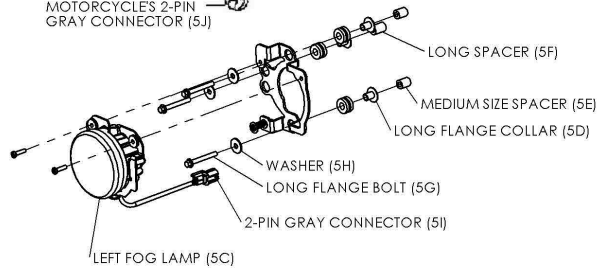
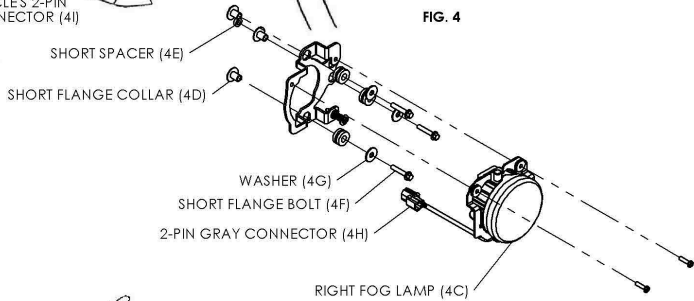

FIG. 6

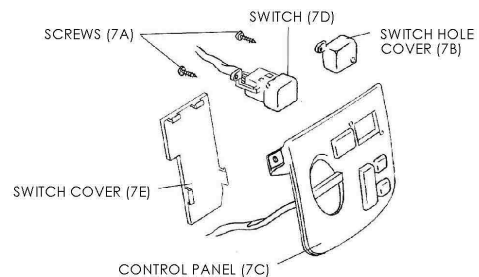

FIG. 7